

6mm Ultra-Thin Magnetic Track Light

Upgraded Appearance

PRODUCT DETAILS



Grille Light



Flood Light



Folding Light



Track Light



Dropline Light

10W 20W Magnetic Track Spot Light

Structure & size

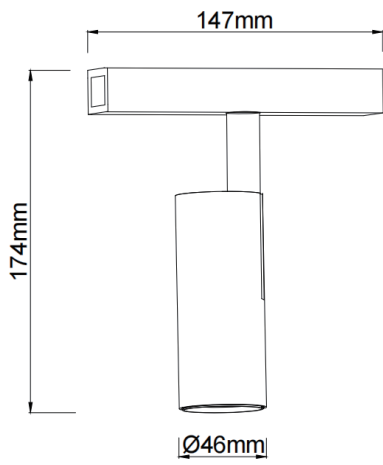

Model No. TX2150S-10

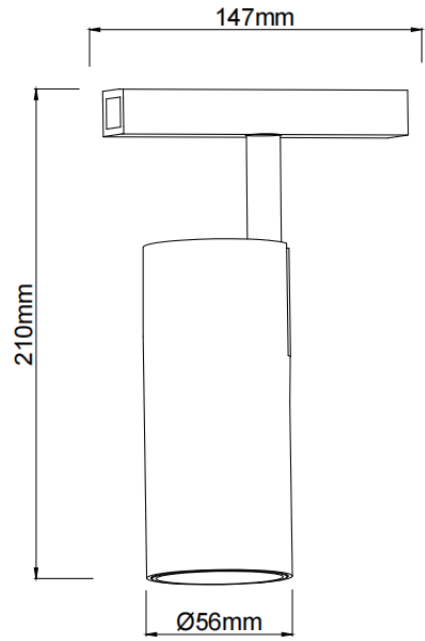

Model No. TX2150S-20

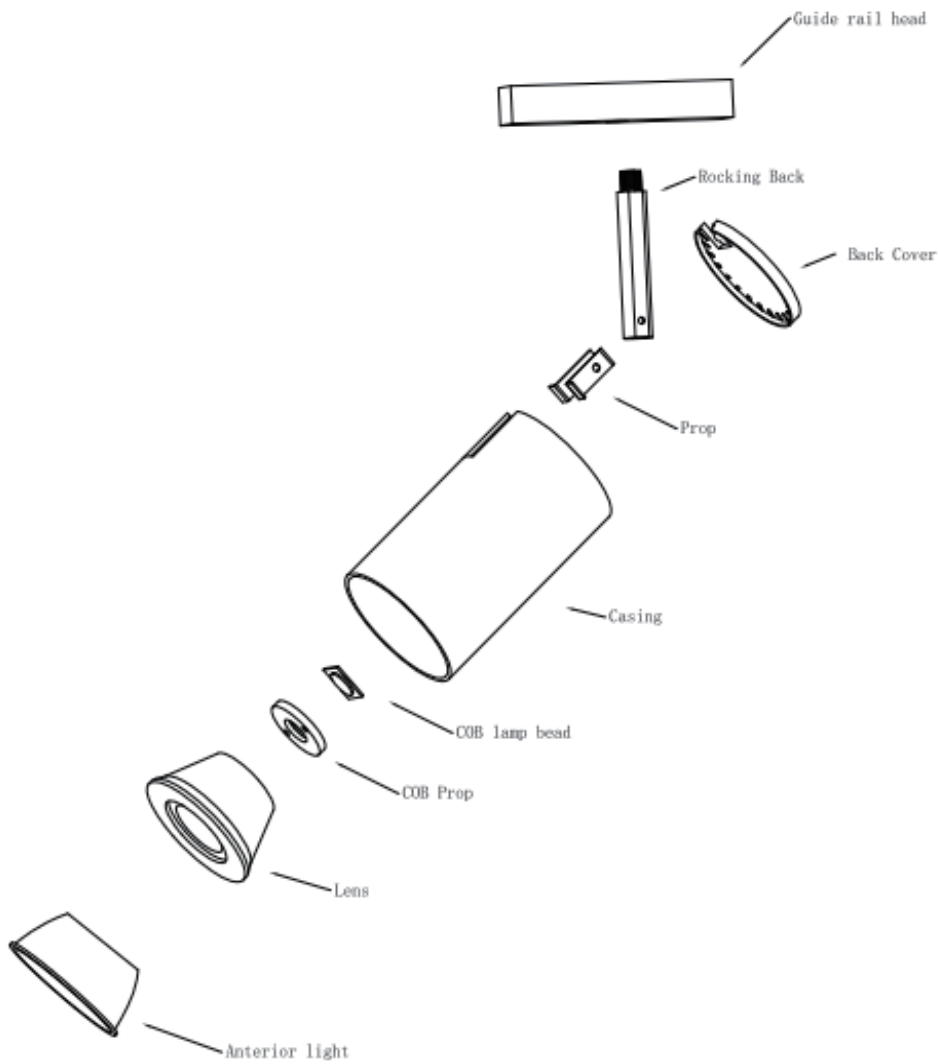

Performance & parameter of product

	Model No.	TX2140S-10			TX2150-20		
	lamp	warm white	natural white	cool white	warm white	natural white	cool white
performance parameter	lumen (lm)	1300	1360	1360	1900	2000	2000
	color temperature (K)	3000K	4200K	6500K	3000K	4200K	6500K
	CRI	>80			>80		
	type of LED	COB			COB		
	beam angle	34			34		
	decay rate (%)	1000 hours no more than 3%			1000 hours no more than 3%		
	total power (W)	10W			20W		
	lifespan (Hrs)	≥30000Hrs			≥30000Hrs		
	high voltage testing	500Vac/1min			500Vac/1min		
	LED parameter	lighting efficiency	136lm/W			130lm/W	
chip quantity		6			12		
series-parallel way		2B10C			2B16C		
voltage		48V			48V		
current		300mA			300mA		
driver parameter	input parameter	48V DC			48V DC		
	power factor	>0.5			>0.5		
	output parameter	50V			50V		
structure parameter	material	AL+PC			AL+PC		
	dimension	147X46X174mm			147X56X210mm		
	cut-out	/			/		
	protection class	calss III			calss III		
	IP	IP20			IP20		

Installation instructions

Installation instructions:

1. Switch off the power.
2. Install the luminaire into the guide rail groove .
3. Check that everything is in order .
4. Switch on the power if above steps done properly without any mistakes.

1

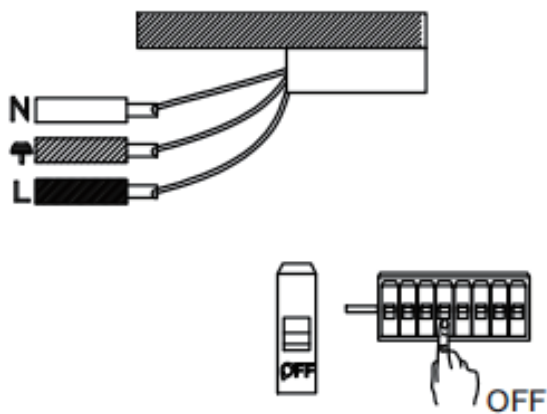

2

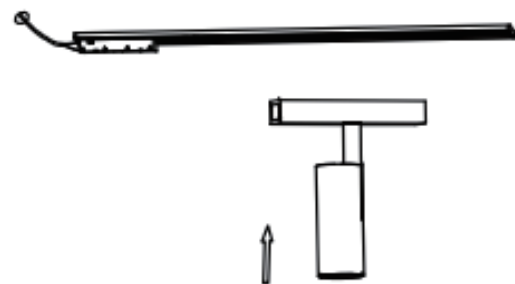

3

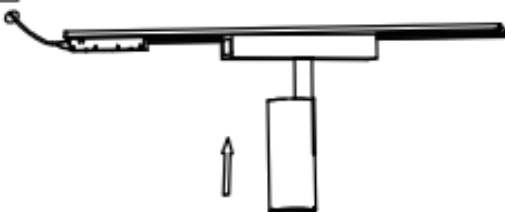

4

